

FILTERNOX OPTIMIST 312606 FILTER LAYOUT AND DIMENSIONS

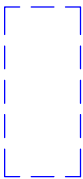

Free space for maintenance

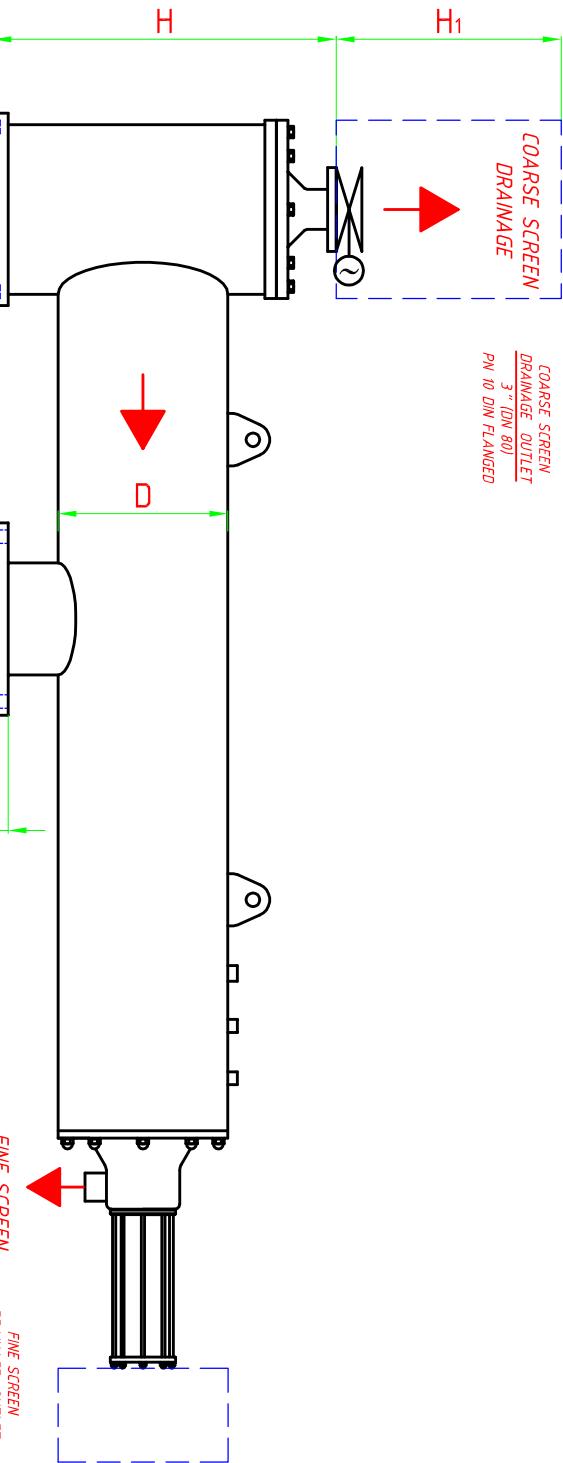
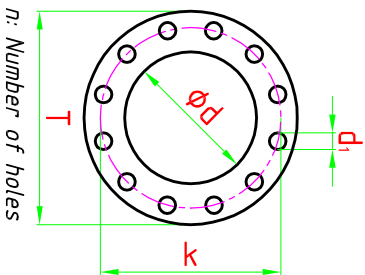

Body Material:	ALSI 304
Screen Material:	ALSI 316
Max. Operating Pressure:	10 bar
Min. Inlet Pressure Required During back-flush:	2 bar
Max. Operating Temperature:	55 °C
Pressure Loss at Max. Flow Rate:	0.2 bar
Approximate back-flush time:	20-30 sec. max.
Approximate back-flush water consumption:	150-200 l/l back-flush
Coarse Screen back-flush Outlet:	Automatic valve
Fine Screen Control System:	Hydraulic or Electrical
Coarse Screen Control System:	Timer

For high pressure, high temperature and different materials, custom made filters can be produced.

INLET/OUTLET		FLANGE SIZES ND 10 - DIN 2576						A		C	D	E	H	H ₁	L	L ₁	WEIGHT(kg)		MAX. FLOW RATE	SCREEN AREA
inch	mm	d	T	K	d ₁	n	t										FULL	EMPTY	m ³ /h	cm ²
6	150	168.2	285	240	22	8	22	900	1217	12"	338	658	865	2625	1700		410	180	200	6500

Inlet and Coarse Screen drainage directions can be used both ways for 8" (DN 200) and wider inlet-outlet diameter. Filters. All dimensions are in millimeters.